

CADD USER: Benjamin Lucas FILE: C:\USERS\B\Lucas\PROJECTS\200604 - 2250 LONGVIEW CIRCLE - HARLAND HESS\WORKING FILES\CADD\DWG\PLAN SHEETS\C000 - EROS.DWG PLOT SCALE: 1:1 PLOT DATE: 9/21/2020 4:25 PM

LONGVIEW CIRCLE

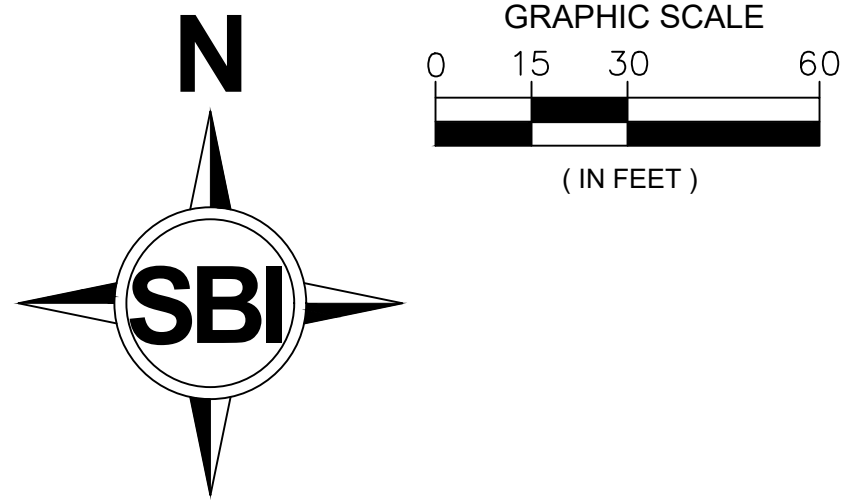
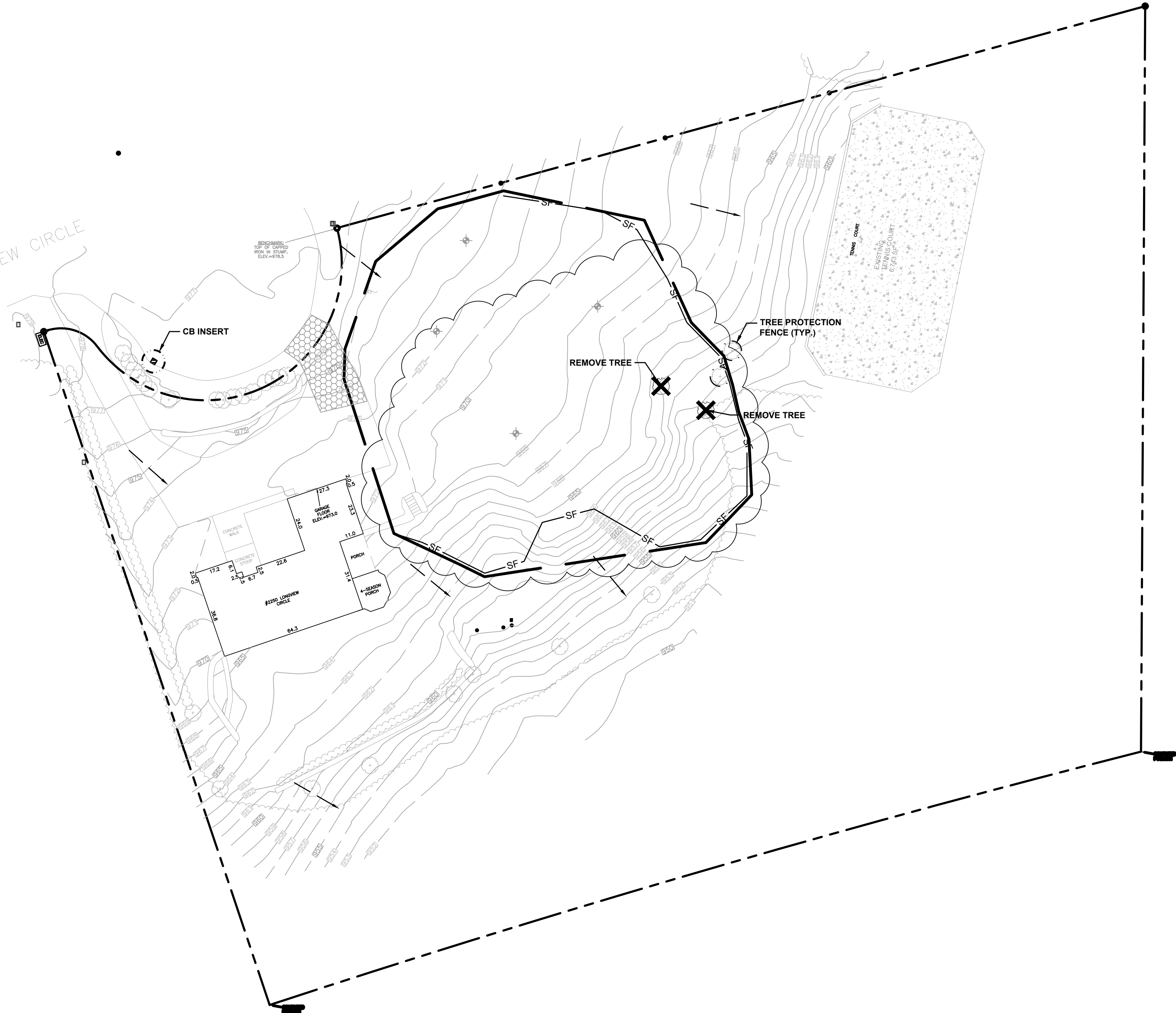

### LEGEND

- PROPERTY LINE
- LIMITS OF CONSTRUCTION
- BUILDING
- TOPOGRAPHIC INDEX CONTOUR
- TOPOGRAPHIC CONTOUR
- CURB & GUTTER
- STORM SEWER
- DRAINTILE
- SWALE
- SOIL BORINGS
- CONSTRUCTION ENTRANCE
- TREE PROTECTION FENCE
- INLET PROTECTION
- SILT FENCE
- DIRECTION OF OVERLAND FLOW

### EXISTING

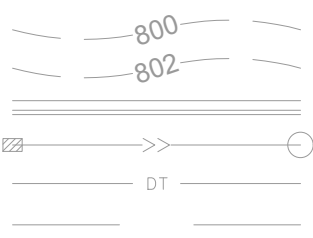

### GENERAL EROSION AND SEDIMENTATION CONTROL NOTES:

- CONTRACTOR MUST NOTIFY CITY AND WATERSHED INSPECTOR PRIOR TO ANY LAND DISTURBANCES. FAILURE TO DO SO MAY RESULT IN FINES, THE REVOCATION OF PERMIT AND A STOP WORK ORDER BEING ISSUED.
- INSTALL PERIMETER EROSION CONTROL AT THE LOCATIONS SHOWN ON THE PLANS PRIOR TO COMMENCEMENT OF ANY LAND DISTURBANCE OR CONSTRUCTION ACTIVITIES. SILT FENCE SHALL FOLLOW EXISTING CONTOURS AS CLOSELY AS FEASIBLE.
- BEFORE BEGINNING CONSTRUCTION, INSTALL A TEMPORARY ROCK CONSTRUCTION ENTRANCE AT EACH POINT WHERE VEHICLES EXIT THE CONSTRUCTION SITE. USE 2 INCH OR GREATER DIAMETER ROCK IN A LAYER AT LEAST 6 INCHES THICK ACROSS THE ENTIRE WIDTH OF THE ENTRANCE. EXTEND THE ROCK ENTRANCE AT LEAST 50 FEET INTO THE CONSTRUCTION ZONE USING A GEO-TEXTILE FABRIC BENEATH THE AGGREGATE TO PREVENT MIGRATION OF SOIL INTO THE ROCK FROM BELOW.
- GENERAL CONTRACTOR SHALL DENOTE ON PLAN THE TEMPORARY PARKING AND STORAGE AREA WHICH SHALL ALSO BE USED AS THE EQUIPMENT MAINTENANCE AND CLEANING AREA, EMPLOYEE PARKING AREA, AND AREA FOR LOCATION PORTABLE FACILITIES, OFFICE TRAILERS AND TOILET FACILITIES.
- REMOVE ALL SOILS AND SEDIMENTS TRACKED OR OTHERWISE DEPOSITED ONTO PUBLIC AND PRIVATE PAVEMENT AREAS. REMOVAL SHALL BE ON A DAILY BASIS WHEN TRACKING OCCURS AND MAY BE ORDERED BY MINNEAPOLIS INSPECTORS AT ANY TIME IF CONDITIONS WARRANT. SWEEPING SHALL BE MAINTAINED THROUGHOUT THE DURATION OF THE CONSTRUCTION AND DONE IN A MANNER TO PREVENT DUST BEING BLOWN TO ADJACENT PROPERTIES.
- INSTALL INLET PROTECTION AT ALL PUBLIC AND PRIVATE CATCH BASIN INLETS, WHICH RECEIVE RUNOFF FROM THE DISTURBED AREAS. CONTRACTOR SHALL CLEAN, REMOVE SEDIMENT OR REPLACE STORM DRAIN INLET PROTECTION DEVICES ON A ROUTINE BASIS SUCH THAT THE DEVICES ARE FULLY FUNCTIONAL FOR THE NEXT RAIN EVENT. SEDIMENT DEPOSITED IN AND/OR PLUGGING DRAINAGE SYSTEMS IS THE RESPONSIBILITY OF THE CONTRACTOR. HAY BALES OR FILTER FABRIC WRAPPED GRATES ARE NOT ALLOWED FOR INLET PROTECTION.
- LOCATE SOIL OR DIRT STOCKPILES NO LESS THAN 25 FEET FROM ANY PUBLIC OR PRIVATE ROADWAY OR DRAINAGE CHANNEL. IF REMAINING FOR MORE THAN SEVEN DAYS, STABILIZE THE STOCKPILES BY MULCHING, VEGETATIVE COVER, TARPS, OR OTHER MEANS. CONTROL EROSION FROM ALL STOCKPILES BY PLACING SILT BARRIERS AROUND THE PILES. TEMPORARY STOCKPILES LOCATED ON PAVED SURFACES MUST BE NO LESS THAN TWO FEET FROM THE DRAINAGE/GUTTER LINE AND SHALL BE COVERED IF LEFT MORE THAN 24 HOURS.
- MAINTAIN ALL TEMPORARY EROSION AND SEDIMENT CONTROL DEVICES IN PLACE UNTIL THE CONTRIBUTING DRAINAGE AREA HAS BEEN STABILIZED. INSPECT TEMPORARY EROSION AND SEDIMENT CONTROL DEVICES ON A DAILY BASIS AND REPLACE DETERIORATED, DAMAGED, OR ROTTED EROSION CONTROL DEVICES IMMEDIATELY.
- TEMPORARILY OR PERMANENTLY STABILIZE ALL CONSTRUCTION AREAS WHICH HAVE UNDERGONE FINAL GRADING, AND ALL AREAS IN WHICH GRADING OR SIDE BUILDING CONSTRUCTION OPERATIONS ARE NOT ACTIVELY UNDERWAY AGAINST EROSION DUE TO RAIN, WIND AND RUNNING WATER WITHIN 7 DAYS. USE SEE AND MULCH, EROSION CONTROL MATTING, AND/OR SODDING AND STAKING IN GREEN SPACE AREAS. REMOVE ALL TEMPORARY SYNTHETIC, STRUCTURAL, NON-BIODEGRADABLE EROSION AND SEDIMENT CONTROL DEVICES AFTER THE SITE HAS UNDERGONE FINAL STABILIZATION WITH PERMANENT VEGETATION ESTABLISHMENT. FINAL STABILIZATION FOR PURPOSES OF THIS REMOVAL IS 70% ESTABLISHED COVER OVER DENUDED AREA.
- READY MIXED CONCRETE AND CONCRETE BATCH/MIX PLANTS ARE PROHIBITED WITHIN THE PUBLIC RIGHT OF WAY. ALL CONCRETE RELATED PRODUCTION, CLEANING AND MIXING ACTIVITIES SHALL BE DONE IN THE DESIGNATED CONCRETE MIXING/WASHOUT LOCATIONS AS DETERMINED BY THE CONTRACTOR. UNDER NO CIRCUMSTANCES MAY WASHOUT WATER DRAIN INTO THE PUBLIC RIGHT OF WAY OR INTO ANY PUBLIC OR PRIVATE STORM DRAIN CONVEYANCE.
- DUE TO THE GRADE CHANGES DURING THE DEVELOPMENT OF THE PROJECT, CONTRACTOR SHALL BE RESPONSIBLE FOR ADJUSTING THE EROSION CONTROL MEASURES TO PREVENT EROSION.
- CHANGES TO APPROVED EROSION CONTROL PLAN MUST BE APPROVED BY THE EROSION CONTROL INSPECTOR PRIOR TO IMPLEMENTATION. CONTRACTOR TO PROVIDE INSTALLATION AND DETAILS FOR ALL PROPOSED ALTERNATE TYPE DEVICES.
- STREET SWEEPING SHALL BE PERFORMED IF SEDIMENT COLLECTS ON STREETS.
- ALL CONSTRUCTION SHALL BE STABILIZED AT THE END OF EACH WORKING DAY, THIS INCLUDES BACKFILLING OF TRENCHES FOR UTILITY CONSTRUCTION AND PLACEMENT OF GRAVEL OR BITUMINOUS PAVING FOR ROAD CONSTRUCTION.

### PHASE I EROSION CONTROL MATERIALS QUANTITIES

ITEM	UNIT	QUANTITY
SILT FENCE	LINEAR FEET	375
EROSION CONTROL BLANKET	SQUARE FEET	XXX
CONSTRUCTION ROCK ENTRANCE	EACH	1
INLET PROTECTION DEVICE	EACH	1
TREE PROTECTION RING	EACH	2
BIO LOG	LINEAR FEET	XXX

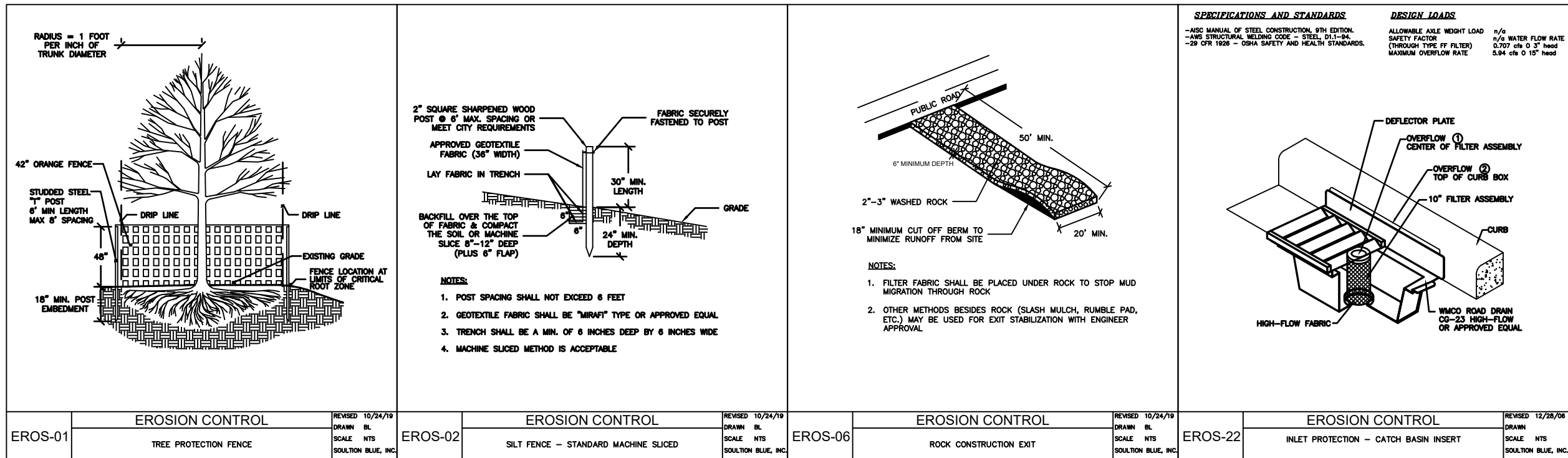

### BENCHMARKS (BM)

BEARINGS SHOWN ARE ON HENNEPIN COUNTY COORDINATES  
BM: TOP OF CAPPED IRON IN STUMP  
ELEVATION: 978.50 (NGVD 29 DATUM)

**Solution Blue**  
water matters<sup>®</sup>

444 Cedar Street, Suite 1005  
Saint Paul, MN 55101

651-294-0038  
www.SolutionBlue.com

## 2250 LONGVIEW CIRCLE RESIDENCE

2250 LONGVIEW CIRCLE, ORONO, MN 55356  
INTEGRITY CONSTRUCTION & EXTERIORS INC.  
17149 LINCOLN STREET N.E. #300

### SUMMARY

DESIGNED: BJL DRAWN: BJL  
REVIEWED: BJL  
PHASE: IFC INITIAL ISSUE: 08/04/20

### REVISION HISTORY

#	DATE	DESCRIPTION
01	09/21/2020	GARAGE LAYOUT REVISION

### CERTIFICATION

I HEREBY CERTIFY THAT THIS PLAN, SPECIFICATION OR REPORT WAS PREPARED BY ME OR UNDER MY DIRECT SUPERVISION AND THAT I AM A DULY LICENSED PROFESSIONAL ENGINEER UNDER THE LAWS OF THE STATE OF MINNESOTA.

*Benjamin Lucas*  
BENJAMIN LUCAS

DATE: 09.21.2020 REG. NO. 54265

EROSION & SEDIMENT CONTROL PLAN - EXISTING CONDITIONS

SOLUTION BLUE PROJECT NO: 200604

C210

COPYRIGHT © 2020 BY SOLUTION BLUE INC. ALL RIGHTS RESERVED



Know what's below.  
Call before you dig.

STATE LAW: 48 HOURS BEFORE EXCAVATING OR DEMOLISHING BUILDINGS, CALL 811 FOR FIELD LOCATION OF UNDERGROUND UTILITY LINES. THIS SERVICE LOCATES UTILITY OWNED LINES BUT NOT PRIVATE LINES.

THE LOCATIONS OF UNDERGROUND UTILITIES ARE SHOWN IN AN APPROXIMATE WAY ONLY AND HAVE NOT BEEN INDEPENDENTLY VERIFIED. THE EXACT LOCATION OF ALL UTILITIES (PUBLIC AND PRIVATE) MUST BE DETERMINED BEFORE COMMENCING WORK.



CADD USER: Benjamin Lucas FILE: C:\USERS\BILUCAS\PROJECTS\200604 - 2250 LONGVIEW CIRCLE - HARLAND HESS\WORKING FILES\CADD\DWG\PLAN SHEETS\C000 - EROS.DWG PLOT SCALE: 1:1 PLOT DATE: 9/21/2020 4:25 PM

LONGVIEW CIRCLE

CB INSERT

TREE PROTECTION FENCE (TYP.)

#### PHASE 2 EROSION CONTROL MATERIALS QUANTITIES

ITEM	UNIT	QUANTITY
SILT FENCE	LINEAR FEET	375
EROSION CONTROL BLANKET	SQUARE FEET	XXX
CONSTRUCTION ROCK ENTRANCE	EACH	1
INLET PROTECTION DEVICE	EACH	1
TREE PROTECTION RING	EACH	2
BIO LOG	LINEAR FEET	XXX

EROSION CONTROL		REVISION	DATE	BY	SCALE	UNIT
EROS-01	TREE PROTECTION FENCE	REVISED	10/26/19	SHAW	1/8"	HALFTON BLUE, INC.
EROS-02	SILT FENCE - STANDARD MACHINE SLICED	REVISED	10/26/19	SHAW	1/8"	HALFTON BLUE, INC.
EROS-06	ROCK CONSTRUCTION EXT	REVISED	10/26/19	SHAW	1/8"	HALFTON BLUE, INC.
EROS-22	INLET PROTECTION - CATCH BASIN INSERT	REVISED	10/26/19	SHAW	1/8"	HALFTON BLUE, INC.

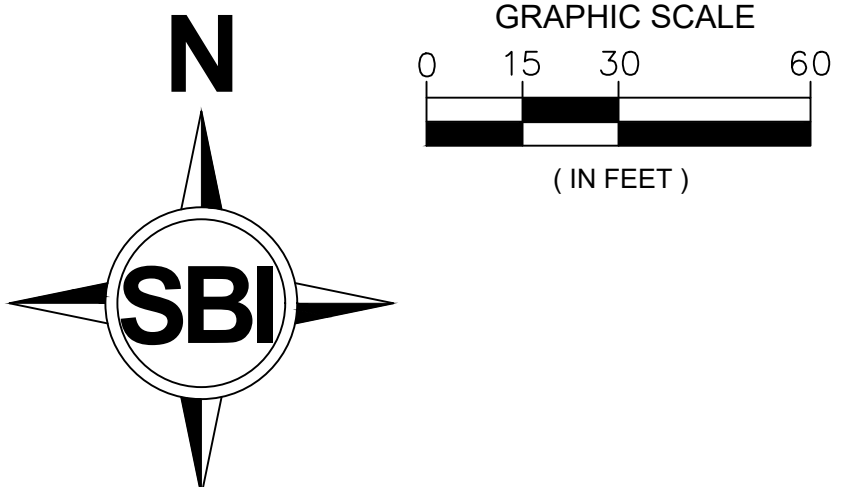

#### LEGEND

	PROPOSED	EXISTING
PROPERTY LINE	---	---
LIMITS OF CONSTRUCTION	---	---
BUILDING	---	---
TOPOGRAPHIC INDEX CONTOUR	800	800
TOPOGRAPHIC CONTOUR	802	802
CURB & GUTTER	---	---
STORM SEWER	---	---
DRAINTILE	---	---
SWALE	---	---
WETLAND	---	---
CONSTRUCTION ENTRANCE	---	---
TREE PROTECTION FENCE	---	---
INLET PROTECTION	---	---
SILT FENCE	SF	SF
DIRECTION OF OVERLAND FLOW	---	---

#### GENERAL EROSION AND SEDIMENTATION CONTROL NOTES:

- CONTRACTOR MUST NOTIFY CITY AND WATERSHED INSPECTOR PRIOR TO ANY LAND DISTURBANCES. FAILURE TO DO SO MAY RESULT IN FINES, THE REVOCATION OF PERMIT AND A STOP WORK ORDER BEING ISSUED.
- INSTALL PERIMETER EROSION CONTROL AT THE LOCATIONS SHOWN ON THE PLANS PRIOR TO COMMENCEMENT OF ANY LAND DISTURBANCE OR CONSTRUCTION ACTIVITIES. SILT FENCE SHALL FOLLOW EXISTING CONTOURS AS CLOSELY AS FEASIBLE.
- BEFORE BEGINNING CONSTRUCTION, INSTALL A TEMPORARY ROCK CONSTRUCTION ENTRANCE AT EACH POINT WHERE VEHICLES EXIT THE CONSTRUCTION SITE. USE 2 INCH OR GREATER DIAMETER ROCK IN A LAYER AT LEAST 6 INCHES THICK ACROSS THE ENTIRE WIDTH OF THE ENTRANCE. EXTEND THE ROCK ENTRANCE AT LEAST 50 FEET INTO THE CONSTRUCTION ZONE USING A GEO-TEXTILE FABRIC BENEATH THE AGGREGATE TO PREVENT MIGRATION OF SOIL INTO THE ROCK FROM BELOW.
- GENERAL CONTRACTOR SHALL DENOTE ON PLAN THE TEMPORARY PARKING AND STORAGE AREA WHICH SHALL ALSO BE USED AS THE EQUIPMENT MAINTENANCE AND CLEANING AREA, EMPLOYEE PARKING AREA, AND AREA FOR LOCATION PORTABLE FACILITIES, OFFICE TRAILERS AND TOILET FACILITIES.
- REMOVE ALL SOILS AND SEDIMENTS TRACKED OR OTHERWISE DEPOSITED ONTO PUBLIC AND PRIVATE PAVEMENT AREAS. REMOVAL SHALL BE ON A DAILY BASIS WHEN TRACKING OCCURS AND MAY BE ORDERED BY MINNEAPOLIS INSPECTORS AT ANY TIME IF CONDITIONS WARRANT. SWEEPING SHALL BE MAINTAINED THROUGHOUT THE DURATION OF THE CONSTRUCTION AND DONE IN A MANNER TO PREVENT DUST BEING BLOWN TO ADJACENT PROPERTIES.
- INSTALL INLET PROTECTION AT ALL PUBLIC AND PRIVATE CATCH BASIN INLETS, WHICH RECEIVE RUNOFF FROM THE DISTURBED AREAS. CONTRACTOR SHALL CLEAN, REMOVE SEDIMENT OR REPLACE STORM DRAIN INLET PROTECTION DEVICES ON A ROUTINE BASIS SUCH THAT THE DEVICES ARE FULLY FUNCTIONAL FOR THE NEXT RAIN EVENT. SEDIMENT DEPOSITED IN AND/OR PLUGGING DRAINAGE SYSTEMS IS THE RESPONSIBILITY OF THE CONTRACTOR. HAY BALES OR FILTER FABRIC WRAPPED GRATES ARE NOT ALLOWED FOR INLET PROTECTION.
- LOCATE SOIL OR DIRT STOCKPILES NO LESS THAN 25 FEET FROM ANY PUBLIC OR PRIVATE ROADWAY OR DRAINAGE CHANNEL. IF REMAINING FOR MORE THAN SEVEN DAYS, STABILIZE THE STOCKPILES BY MULCHING, VEGETATIVE COVER, TARPES, OR OTHER MEANS. CONTROL EROSION FROM ALL STOCKPILES BY PLACING SILT BARRIERS AROUND THE PILES. TEMPORARY STOCKPILES LOCATED ON PAVED SURFACES MUST BE NO LESS THAN TWO FEET FROM THE DRAINAGE/GUTTER LINE AND SHALL BE COVERED IF LEFT MORE THAN 24 HOURS.
- MAINTAIN ALL TEMPORARY EROSION AND SEDIMENT CONTROL DEVICES IN PLACE UNTIL THE CONTRIBUTING DRAINAGE AREA HAS BEEN STABILIZED. INSPECT TEMPORARY EROSION AND SEDIMENT CONTROL DEVICES ON A DAILY BASIS AND REPLACE DETERIORATED, DAMAGED, OR ROTTED EROSION CONTROL DEVICES IMMEDIATELY.
- TEMPORARILY OR PERMANENTLY STABILIZE ALL CONSTRUCTION AREAS WHICH HAVE UNDERGONE FINAL GRADING, AND ALL AREAS IN WHICH GRADING OR SIDE BUILDING CONSTRUCTION OPERATIONS ARE NOT ACTIVELY UNDERWAY AGAINST EROSION DUE TO RAIN, WIND AND RUNNING WATER WITHIN 7 DAYS. USE SEE AND MULCH, EROSION CONTROL MATTING, AND/OR SODDING AND STAKING IN GREEN SPACE AREAS. REMOVE ALL TEMPORARY SYNTHETIC, STRUCTURAL, NON-BIODEGRADABLE EROSION AND SEDIMENT CONTROL DEVICES AFTER THE SITE HAS UNDERGONE FINAL STABILIZATION WITH PERMANENT VEGETATION ESTABLISHMENT. FINAL STABILIZATION FOR PURPOSES OF THIS REMOVAL IS 70% ESTABLISHED COVER OVER DENUDED AREA.
- READY MIXED CONCRETE AND CONCRETE BATCH/MIX PLANTS ARE PROHIBITED WITHIN THE PUBLIC RIGHT OF WAY. ALL CONCRETE RELATED PRODUCTION, CLEANING AND MIXING ACTIVITIES SHALL BE DONE IN THE DESIGNATED CONCRETE MIXING/WASHOUT LOCATIONS AS DETERMINED BY THE CONTRACTOR. UNDER NO CIRCUMSTANCES MAY WASHOUT WATER DRAIN INTO THE PUBLIC RIGHT OF WAY OR INTO ANY PUBLIC OR PRIVATE STORM DRAIN CONVEYANCE.
- DUE TO THE GRADE CHANGES DURING THE DEVELOPMENT OF THE PROJECT, CONTRACTOR SHALL BE RESPONSIBLE FOR ADJUSTING THE EROSION CONTROL MEASURES TO PREVENT EROSION.
- CHANGES TO APPROVED EROSION CONTROL PLAN MUST BE APPROVED BY THE EROSION CONTROL INSPECTOR PRIOR TO IMPLEMENTATION. CONTRACTOR TO PROVIDE INSTALLATION AND DETAILS FOR ALL PROPOSED ALTERNATE TYPE DEVICES.
- STREET SWEEPING SHALL BE PERFORMED IF SEDIMENT COLLECTS ON STREETS.
- ALL CONSTRUCTION SHALL BE STABILIZED AT THE END OF EACH WORKING DAY, THIS INCLUDES BACKFILLING OF TRENCHES FOR UTILITY CONSTRUCTION AND PLACEMENT OF GRAVEL OR BITUMINOUS PAVING FOR ROAD CONSTRUCTION.

#### BENCHMARKS (BM)

BEARINGS SHOWN ARE ON HENNEPIN COUNTY COORDINATES  
BM: TOP OF CAPPED IRON IN STUMP  
ELEVATION: 978.50 (NGVD 29 DATUM)



## 2250 LONGVIEW CIRCLE RESIDENCE

2250 LONGVIEW CIRCLE, ORONO, MN 55356  
INTEGRITY CONSTRUCTION & EXTERIORS INC.  
17149 LINCOLN STREET N.E. #300

#### SUMMARY

DESIGNED: BJL DRAWN: BJL  
REVIEWED: BJL  
PHASE: IFC INITIAL ISSUE: 08/04/20

#### REVISION HISTORY

#	DATE	DESCRIPTION
01	09/21/2020	GARAGE LAYOUT REVISION

#### CERTIFICATION

I HEREBY CERTIFY THAT THIS PLAN, SPECIFICATION OR REPORT WAS PREPARED BY ME OR UNDER MY DIRECT SUPERVISION AND THAT I AM A DULY LICENSED PROFESSIONAL ENGINEER UNDER THE LAWS OF THE STATE OF MINNESOTA.

*Benjamin Lucas*  
BENJAMIN LUCAS

DATE: 09.21.2020 REG. NO. 54265

EROSION & SEDIMENT CONTROL PLAN - PROPOSED CONDITIONS

SOLUTION BLUE PROJECT NO: 200604

C211

COPYRIGHT © 2020 BY SOLUTION BLUE INC. ALL RIGHTS RESERVED



CADD USER: Benjamin Lucas FILE: C:\USERS\BLUCAS\DROPBOX\PROJECTS\200604 - 2250 LONGVIEW CIRCLE - HARLAND HESS\WORKING FILES\CADD\DWG\PLAN SHEETS\C400 - GRAD.DWG PLOT SCALE: 1:1 PLOT DATE: 9/21/2020 4:26 PM



STATE LAW: 48 HOURS BEFORE EXCAVATING OR DEMOLISHING BUILDINGS, CALL 811 FOR FIELD LOCATION OF UNDERGROUND UTILITY LINES. THIS SERVICE LOCATES UTILITY OWNED LINES BUT NOT PRIVATE LINES.

THE LOCATIONS OF UNDERGROUND UTILITIES ARE SHOWN IN AN APPROXIMATE WAY ONLY AND HAVE NOT BEEN INDEPENDENTLY VERIFIED. THE EXACT LOCATION OF ALL UTILITIES (PUBLIC AND PRIVATE) MUST BE DETERMINED BEFORE COMMENCING WORK.

LONGVIEW CIRCLE

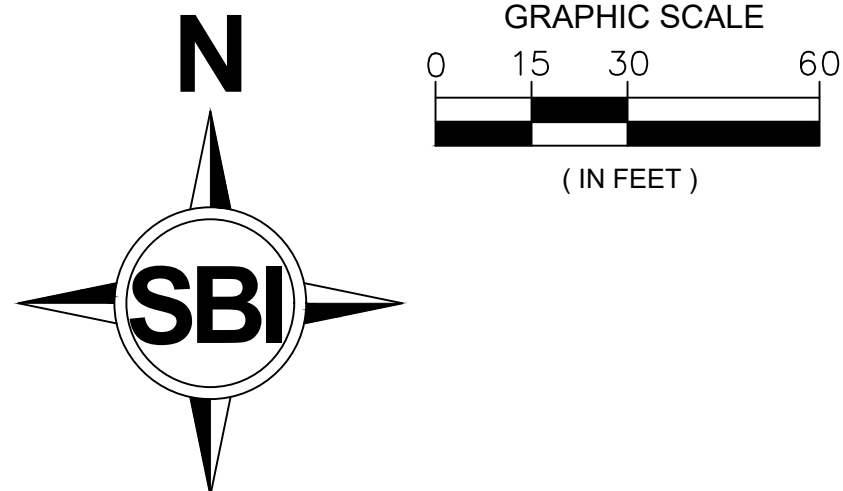
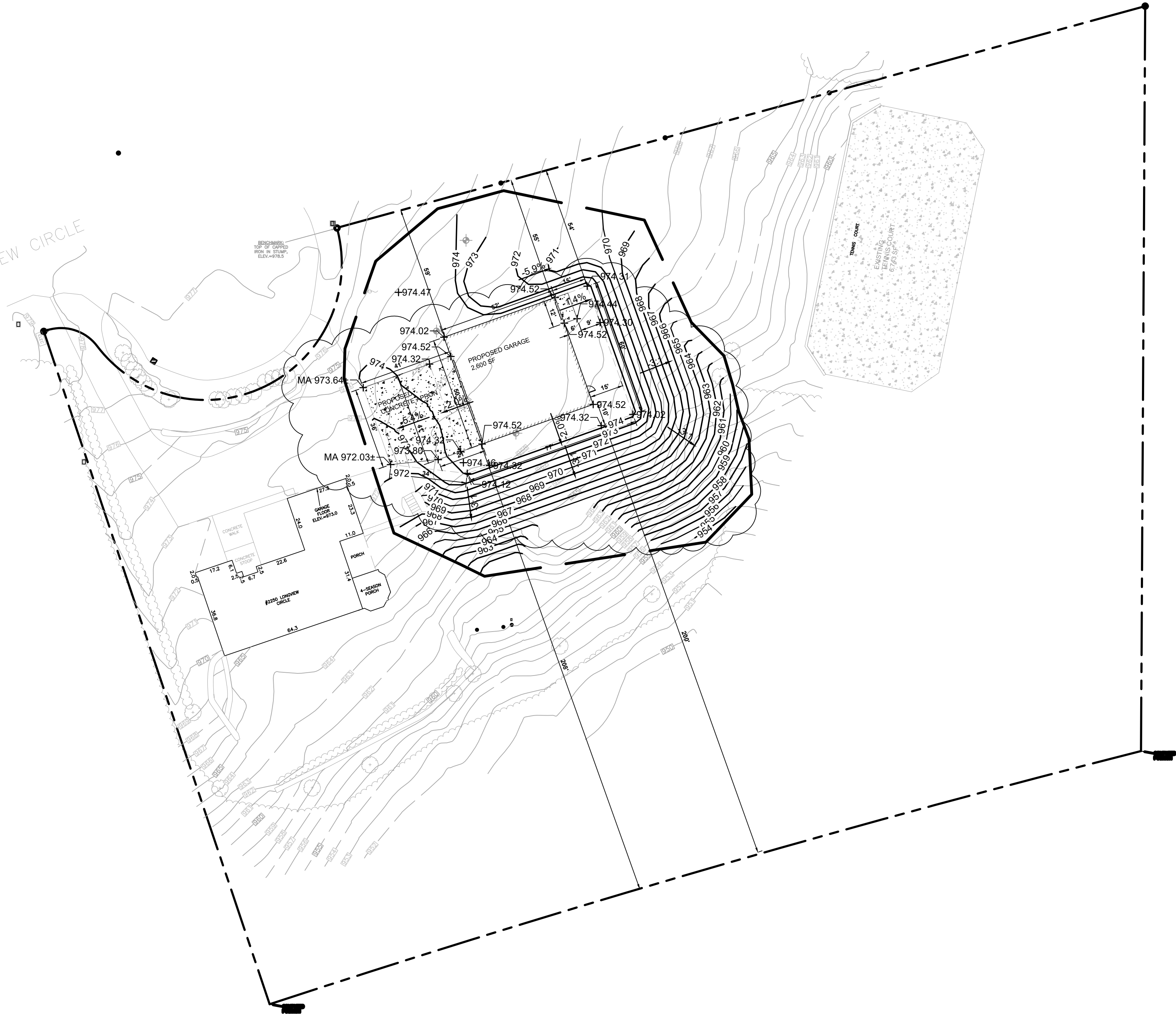

### LEGEND

- PROPERTY LINE
- LIMITS OF CONSTRUCTION
- BUILDING
- TOPOGRAPHIC INDEX CONTOUR
- TOPOGRAPHIC CONTOUR
- CURB & GUTTER
- STORM SEWER
- DRAINTILE
- SWALE
- SOIL BORINGS
- SPOT ELEVATION
- DRAINAGE SLOPE

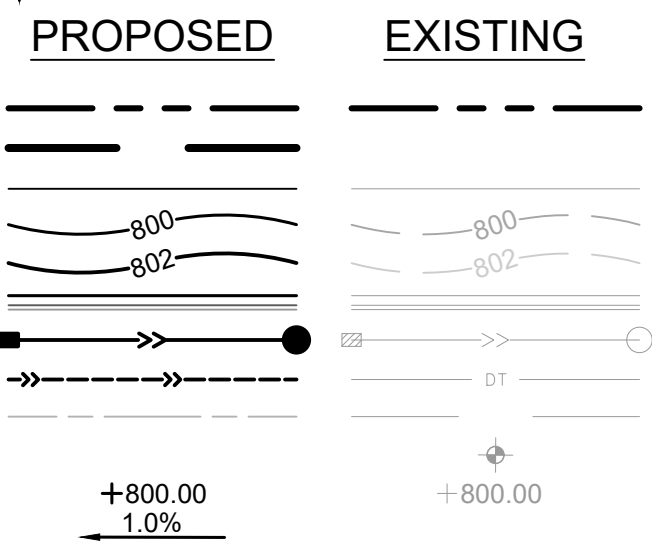

### GENERAL GRADING NOTES:

- ALL EROSION AND SEDIMENTATION CONTROL MEASURES SHALL BE IN PLACE BEFORE BEGINNING SITE GRADING ACTIVITIES.
- CONTRACTOR SHALL BE RESPONSIBLE FOR DETERMINING QUANTITIES OF CUT, FILL AND WASTE MATERIAL TO BE HANDLED, AND FOR THE AMOUNT OF GRADING TO BE DONE. ALL COSTS ASSOCIATED WITH IMPORTING SUITABLE MATERIAL AND EXPORTING UNSUITABLE/EXCESS/WASTE MATERIAL SHALL BE INCLUDED IN THE BID PRICE.
- CONTRACTOR SHALL TAKE ALL PRECAUTIONS NECESSARY TO AVOID PROPERTY DAMAGE TO ADJACENT PROPERTIES DURING THE CONSTRUCTION PHASES OF THIS PROJECT. CONTRACTOR WILL BE HELD SOLELY RESPONSIBLE FOR ANY DAMAGES TO THE ADJACENT PROPERTIES OCCURRING DURING THE CONSTRUCTION PHASES OF THIS PROJECT.
- SAFETY NOTICE TO CONTRACTORS: IN ACCORDANCE WITH GENERALLY ACCEPTED CONSTRUCTION PRACTICES, CONTRACTOR WILL BE SOLELY AND COMPLETELY RESPONSIBLE FOR CONDITIONS ON THE JOB SITE, INCLUDING SAFETY OF ALL PERSONS AND PROPERTY DURING PERFORMANCE OF THE WORK. THIS REQUIREMENT WILL APPLY CONTINUOUSLY AND NOT BE LIMITED TO NORMAL WORKING HOURS. THE DUTY OF THE ENGINEER OR THE DEVELOPER TO CONDUCT CONSTRUCTION REVIEW OF THE CONTRACTOR'S PERFORMANCE IS NOT INTENDED TO INCLUDE REVIEW OF THE ADEQUACY OF THE CONTRACTOR'S SAFETY MEASURES IN, ON OR NEAR THE CONSTRUCTION SITE.
- CONTRACTOR SHALL COMPLETE THE SITE GRADING CONSTRUCTION IN ACCORDANCE WITH THE REQUIREMENTS OF THE OWNER'S SOILS ENGINEER. ALL SOIL TESTING SHALL BE COMPLETED BY THE OWNER'S SOILS ENGINEER. CONTRACTOR SHALL BE RESPONSIBLE FOR COORDINATING ALL REQUIRED SOIL TESTS AND INSPECTIONS WITH THE SOILS ENGINEER.

A GEOTECHNICAL ENGINEERING SOILS REPORT HAS BEEN COMPLETED BY:

COMPANY: SOIL INVESTIGATION & DESIGN, INC.  
ADDRESS: 2809 78TH AVENUE NORTH, BROOKLYN PARK, MN 55444  
PHONE: 651-260-3783  
DATE: 08-03-2020

CONTRACTOR SHALL OBTAIN A COPY OF THIS REPORT.

- PRIOR TO PLACEMENT OF THE AGGREGATE BASE, A TEST ROLL SHALL BE PERFORMED ON THE DRIVEWAY AREA SUBGRADE. THE TEST ROLLING SHALL BE AT THE DIRECTION OF THE SOILS ENGINEER AND SHALL BE COMPLETED IN AREAS AS DIRECTED BY THE SOILS ENGINEER. CORRECTION OF THE SUBGRADE SOILS SHALL BE COMPLETED IN ACCORDANCE WITH THE REQUIREMENTS OF THE SOILS ENGINEER.
- REPLACE ALL SUBGRADE SOIL DISTURBED DURING CONSTRUCTION THAT HAVE BECOME UNSUITABLE AND WILL NOT PASS A TEST ROLL. REMOVE UNSUITABLE SOIL FROM THE SITE AND IMPORT SUITABLE SOIL AT NO ADDITIONAL COST TO THE OWNER.
- CONTRACTOR SHALL STRIP, STOCKPILE AND RE-SPREAD EXISTING ONSITE TOPSOIL, IF MATERIAL IS APPROVED BY THE LANDSCAPE ARCHITECT AND/OR SPECIFICATIONS. PROVIDE A UNIFORM THICKNESS OF 6" MINIMUM IN ALL DISTURBED AREAS TO BE LANDSCAPED.
- CONTRACTOR SHALL DISPOSE OF ANY EXCESS SOIL MATERIAL UNLESS OTHERWISE DIRECTED.
- MAINTAIN TEMPORARY PROTECTION MEASURES DURING CONSTRUCTION ACTIVITIES. SEE SITE REMOVALS PLAN FOR ADDITIONAL INFORMATION. PROVIDE ADDITIONAL PROTECTION AS NECESSARY AS WORK PROGRESSES.
- PROPOSED CONTOURS AND SPOT ELEVATIONS ARE TO FINISHED SURFACE GRADE.
- SPOT ELEVATIONS LABELED MA REFERS TO MATCH EXISTING GRADE.
- PROVIDE POSITIVE DRAINAGE AWAY FROM BUILDINGS AT ALL TIMES.
- NO GRADED SLOPES SHALL EXCEED 3:1 (HORIZONTAL TO VERTICAL) UNLESS OTHERWISE NOTED.
- UNIFORMLY GRADED AREAS WITHIN LIMITS OF GRADING AND PROVIDE A SMOOTH FINISHED SURFACE WITH UNIFORM SLOPES BETWEEN POINTS WHERE ELEVATIONS ARE SHOWN OR BETWEEN SUCH POINTS AND EXISTING GRADES.
- LIMIT THE DISTURBED AREA AS MUCH AS POSSIBLE AND CONDUCT GRADING OPERATIONS IN A MANNER TO MINIMIZE THE POTENTIAL FOR EROSION.

### BENCHMARKS (BM)

BEARINGS SHOWN ARE ON HENNEPIN COUNTY COORDINATES  
BM: TOP OF CAPPED IRON IN STUMP  
ELEVATION: 978.50 (NGVD 29 DATUM)



## 2250 LONGVIEW CIRCLE RESIDENCE

2250 LONGVIEW CIRCLE, ORONO, MN 55356  
INTEGRITY CONSTRUCTION & EXTERIORS INC.  
17149 LINCOLN STREET N.E. #300

### SUMMARY

DESIGNED: BJL DRAWN: BJL  
REVIEWED: BJL  
PHASE: IFC INITIAL ISSUE: 08/04/20

### REVISION HISTORY

#	DATE	DESCRIPTION
01	09/21/2020	GARAGE LAYOUT REVISION

### CERTIFICATION

I HEREBY CERTIFY THAT THIS PLAN, SPECIFICATION OR REPORT WAS PREPARED BY ME OR UNDER MY DIRECT SUPERVISION AND THAT I AM A DULY LICENSED PROFESSIONAL ENGINEER UNDER THE LAWS OF THE STATE OF MINNESOTA.

*Benjamin Lucas*  
BENJAMIN LUCAS

DATE: 09.21.2020 REG. NO. 54265

### GRADING & DRAINAGE PLAN

SOLUTION BLUE PROJECT NO: 200604

# C400