

MINNESOTA DEPARTMENT OF HEALTH  
**WELL AND BORING CONSTRUCTION RECORD**  
 Minnesota Statutes, Chapter 1031

**827833**

WELL OR BORING LOCATION  
 County Name  
**Hennepin**

Township Name: **Orono** Township No.: **117** Range No.: **23** Section No.: **05** Fraction (sm. → lg.): **SE SE SE**

WELL/BORING DEPTH (completed): **220** ft. DATE WORK COMPLETED: **3-20-19**

GPS LOCATION — decimal degrees (to four decimal places).  
 Latitude \_\_\_\_\_ Longitude \_\_\_\_\_

House Number, Street Name, City, and ZIP Code of Well Location  
**3345 Fox St, orono, MN 55356**

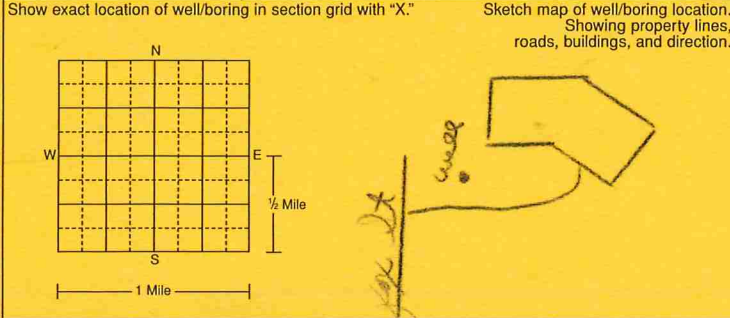

DRILLING METHOD  
 Cable Tool  Driven  Dual Rotary  
 Auger  Rotary  Rotasonic  
 Other

DRILLING FLUID: **bentonite** WELL HYDROFRACTURED?  Yes  No  
 From \_\_\_\_\_ ft. To \_\_\_\_\_ ft.

USE  
 Domestic  Monitoring  Heating/Cooling  
 Noncommunity PWS  Environ. Bore Hole  Industry/Commercial  
 Community PWS  Irrigation  Remedial  
 Elevator  Dewatering

CASING MATERIAL Drive Shoe?  Yes  No HOLE DIAM.  
 Steel  Threaded  Welded  
 Plastic

CASING Diameter Weight Specifications  
**4** in. To **215** ft. \_\_\_\_\_ lbs./ft. \_\_\_\_\_  
 \_\_\_\_\_ in. To \_\_\_\_\_ ft. \_\_\_\_\_ lbs./ft. \_\_\_\_\_  
 \_\_\_\_\_ in. To \_\_\_\_\_ ft. \_\_\_\_\_ lbs./ft. \_\_\_\_\_  
**8** in. To **50** ft.  
**6 1/2** in. To **215** ft.  
**37/8** in. To **220** ft.

PROPERTY OWNER'S NAME/COMPANY NAME  
**Hendel Homes**

Property owner's mailing address if different than well location address indicated above.  
**15250 Wayzata Blvd  
 Wayzata, MN 55391**

SCREEN **Johnson** OPEN HOLE  
 Make **Johnson** From \_\_\_\_\_ ft. To \_\_\_\_\_ ft.  
 Type **stainless stl** Diam. **2"**  
 Slot/Gauze **.010** Length **6'**  
 Set between **215** ft. and **220** ft. FITTINGS **2"x3' leader**

STATIC WATER LEVEL **53** ft.  Below  Above land surface  
 Measured from **top of well** date measured **3-20-19** Dry hole  Yes  No

WELL OWNER'S NAME/COMPANY NAME

Well/boring owner's mailing address if different than property owner's address indicated above.

PUMPING LEVEL (below land surface)  
**200** ft. after **2** hrs. pumping **50+** g.p.m.

WELLHEAD COMPLETION  
 Pileless/adaptor manufacturer **Whitewater** Model \_\_\_\_\_  
 Casing protection  12 in. above grade  
 At-grade  Well House  Hand Pump

GROUT INFORMATION (specify bentonite, cement-sand, neat-cement, concrete, cuttings, or other)  
 Material **bentonite** From **0** To **30** ft. **3** \_\_\_\_\_ Yds.  Bags  
 Material **portland** From **30** To **215** ft. **20** \_\_\_\_\_ Yds.  Bags  
 Material \_\_\_\_\_ From \_\_\_\_\_ To \_\_\_\_\_ ft. \_\_\_\_\_ Yds.  Bags  
 Driven casing seal From \_\_\_\_\_ To \_\_\_\_\_ Bags One bag = 94 lbs. cement or 50 lbs. bentonite

GEOLOGICAL MATERIALS	COLOR	HARDNESS OF MATERIAL	FROM	TO
clay	brown	medium	0	14
clay	gray	medium	14	50
sandy clay	gray	medium	50	112
sand/clay	gray	medium	112	125
sandy clay	gray	medium	125	142
clay	dark gray	medium	142	153
sticky clay	gray	medium	153	165
sandy clay	gray	soft	165	203
course gravel/sand	mix	soft	203	220

NEAREST KNOWN SOURCE OF CONTAMINATION  
 Well is **125** feet **NE** direction from **septic** type  
 Well disinfected upon completion?  Yes  No

PUMP  
 Not installed Date installed **3-21-19**  
 Manufacturer's name **Schaefer**  
 Model Number \_\_\_\_\_ HP **1.5** Volts **230**  
 Length of drop pipe **84** ft. Capacity \_\_\_\_\_ g.p.m.  
 Type:  Submersible  L.S. Turbine  Reciprocating  Jet

ABANDONED WELLS  
 Does property have any not in use and not sealed well(s)?  Yes  No

VARIANCE  
 Was a variance granted from the MDH for this well?  Yes  No TN# \_\_\_\_\_

WELL CONTRACTOR CERTIFICATION  
 This well was drilled under my supervision and in accordance with Minnesota Rules, Chapter 4725. The information contained in this report is true to the best of my knowledge.

REMARKS, ELEVATION, SOURCE OF DATA, etc.  
 Use a second sheet, if needed.

**Don Stodola Well Drilling Co., Inc. 1691**  
 Licensee Business Name Lic. or Reg. No.  
  
**3-28-19**  
 Certified Representative Signature Certified Rep. No. Date

**LOCAL COPY** **827833**

Name of Driller